

FRAMELESS EURO STYLE CABINET STRUCTURE

PLYWOOD BOX (PLY) AND PARTICLE BOARD BOX (PB)

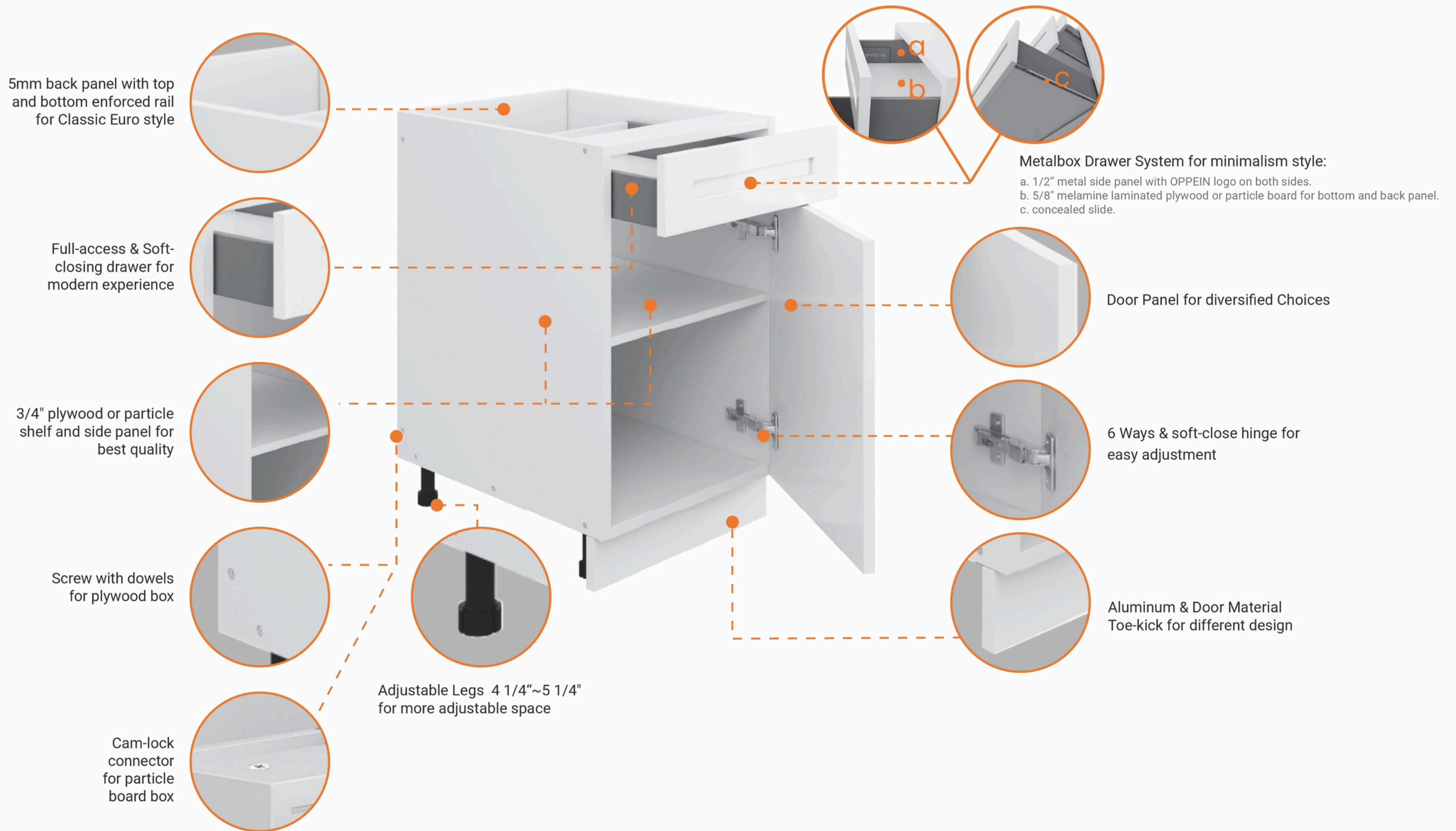



2 Day Pick-Up



Flat Natural Wood
Style Code: MNW
Line: Essential



Flat Smoked Oak
Style Code: MSO
Line: Essential

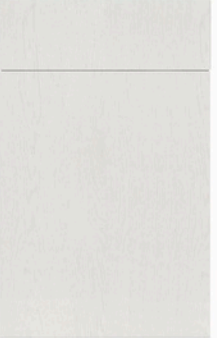

Flat Pure White
Style Code: MPW
Line: Essential



Shaker Pure White
Style Code: SPW
Line: Essential Plus



Skeleton Natural Wood
Style Code: KNW
Line: Trend



Slim Shaker White
Style Code: SSW
Line: Elite



White Single Shaker
Style Code: WSS
Line: Premium



Gray Single Shaker
Style Code: GSS
Line: Premium



Blue Single Shaker
Style Code: BSS
Line: Premium



ESSENTIAL SERIES

Entry Flat Melamine Series
Our most economical cabinet door option—perfect for entry-level projects without sacrificing a clean, modern look. Built with a sturdy particleboard core and a durable melamine surface, this flat-panel design offers a sleek, minimalist appearance with excellent resistance to scratches and everyday wear. Ideal for rental units, budget-conscious builds, or simple contemporary spaces.

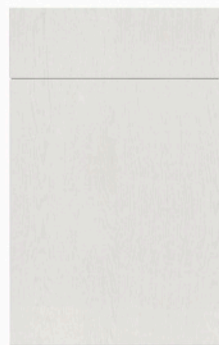

Flat Pure White
Style Code: MPW
Material: Particle board
Finish: Melamine



Flat Natural Wood
Style Code: MNW
Material: Particle board
Finish: Melamine



Flat Smoked Oak
Style Code: MSO
Material: Particle board
Finish: Melamine





ESSENTIAL PLUS SERIES

A timeless budget-friendly shaker door that combines style, durability, and value. Made with a sturdy HDF core wrapped in a smooth wrapping vinyl finish, delivers a crisp pure white look that brightens any space. The classic 5-piece shaker profile offers versatility for both traditional and modern designs, while the wrapping vinyl surface ensures easy cleaning and long-lasting resistance to moisture and wear.



Shaker Pure White
Style Code: SPW
Core: HDF
Finish: Vinyl Wrapping & Melamine





TREND SERIES

The narrow shaker detail gives it a touch of modern styling while maintaining a classic feel.



Skeleton Natural Wood
Style Code: KNW
Core: Particle Board
Finish: Melamine





PREMIUM SERIES

The frame material is E1 HDF, the core material with E1 HDF formaldehyde emission $\leq 0.124 \text{ mg/m}^3$, and the stiles and rails are connected by tenons.



White Single Shaker
 Style Code: WSS
 Material: HDF
 Finish: Lacquer



Gray Single Shaker
 Style Code: GSS
 Material: HDF
 Finish: Lacquer



Blue Single Shaker
 Style Code: BSS
 Material: HDF
 Finish: Lacquer





ELITE SERIES

The narrow shaker detail gives it a touch of modern styling while maintaining a classic feel.



- HDF material
- Greater resistance to impact and torsion
- Great stability, Lower expansion coefficient
- Bending Resistant

Slim Shaker White
Style Code: SSW
Core: HDF
Finish: Lacquer





5 Day Pick-Up

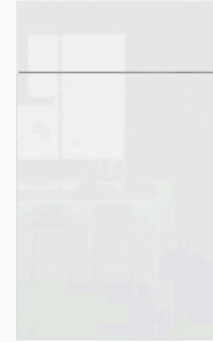

Glossy White
Style Code: PGW
Line: Urban Select

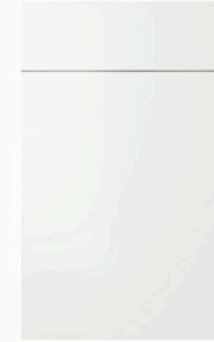

Matt White
Style Code: PMW
Line: Urban Select

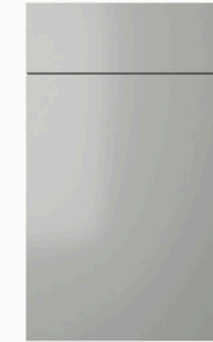

Matt Ash
Style Code: PMA
Line: Signature Prestige



Matt Black
Style Code: PMB
Line: Signature Prestige

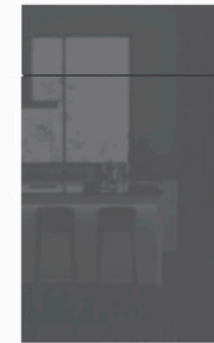

Glossy Gray
Style Code: PGG
Line: Signature Prestige



Matt Gray
Style Code: PMG
Line: Signature Prestige



Glossy Ash
Style Code: PGA
Line: Signature Prestige

URBAN SELECT SERIES

- 1- Having a great effect on the beauty of modern and simple design.
- 2- Superior yellowing resistance performance and ability to avoid discolor.
- 3- Fingerprints disappear instantly, which makes the cabinets clean and beautiful.



Matt White
Style Code: PMW
Core: MDF
Finish: PET

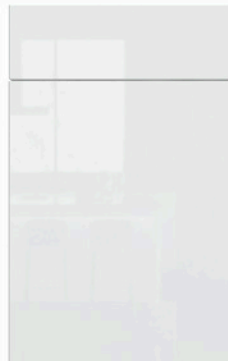

Glossy White
Style Code: PGW
Core: MDF
Finish: PET





**SIGNATURE
PRESTIGE SERIES**

- 1-Having a great effect on the beauty of modern and simple design.
- 2-Superior yellowing resistance performance and ability to avoid discolor.
- 3-Fingerprints disappear instantly, which makes the cabinets clean and beautiful.



Matt Ash Style Code: PMA Core: MDF Finish: PET	Matt Black Style Code: PMB Core: MDF Finish: PET	Matt Gray Style Code: PMG Core: MDF Finish: PET	Glossy Ash Style Code: PGA Core: MDF Finish: PET	Glossy Gray Style Code: PGG Core: MDF Finish: PET
--	--	---	--	---

Cabinet Specifications



1. Base Cabinet (1 Drawer + 1 Door)

SKU	Dimensions
B12	12"W x 30"H x 23 7/8"D
B15	15"W x 30"H x 23 7/8"D
B18	18"W x 30"H x 23 7/8"D
BTC18(Trash Can Unit)	18"W x 30"H x 23 7/8"D
B21	21"W x 30"H x 23 7/8"D

Includes:

- One (1) universal cabinet box.
- One (1) drawer with metalbox and soft close slide.
- One (1) door with HINGE105° (6 ways & soft close).
- One (1) adjustable shelf with shelf pegs.
- Four (4) adjustable Legs 4 1/4"~5 1/4"
- Screws or camlock, dowels and required hardware.

NOTE:

- Use BEP/MBEP panels to cover exterior sides if exposed.
- Need to install TK8/A-TK10/B-TK10 at the bottom of the cabinet.

2. Base Cabinet (1 Drawer + 2 Door)

SKU	Dimensions
B24	24"W x 30"H x 23 7/8"D
B27	27"W x 30"H x 23 7/8"D
B30	30"W x 30"H x 23 7/8"D
B33	33"W x 30"H x 23 7/8"D
B36	36"W x 30"H x 23 7/8"D
B42	42"W x 30"H x 23 7/8"D

Includes:

- One (1) universal cabinet box.
- One (1) drawer with metalbox and soft close slide.
- Two (2) doors with HINGE105° (6 ways & soft close).
- One (1) adjustable shelf with shelf pegs.
- Four (4) adjustable Legs 4 1/4"~5 1/4" for 24"-33"W cabinet, six (6) for 36" & 42"W.
- Screws or camlock, dowels and required hardware.

NOTE:

- Use BEP/MBEP panels to cover exterior sides if exposed.
- Need to install TK8/A-TK10/B-TK10 at the bottom of the cabinet.

Cabinet Specifications



3. Sink Base Cabinet (1 FK Drawer + 2 Door)

SKU	Dimensions
SB30	30"W x 30"H x 23 7/8"D
SB33	33"W x 30"H x 23 7/8"D
SB36	36"W x 30"H x 23 7/8"D
SB42	42"W x 30"H x 23 7/8"D

Includes:

- One (1) universal cabinet box.
- One (1) fake drawer panel.
- Two (2) doors with HINGE105° (6 ways & soft close).
- Four (4) adjustable Legs 4 1/4"~5 1/4" for 30" & 33"W cabinet, six (6) for 36" & 42"W.
- Screws or camlock, dowels and required hardware.

NOTE:

- Use BEP/MBEP panels to cover exterior sides if exposed.
- Need to install TK8/A-TK10/B-TK10 at the bottom of the cabinet.

4. Base Blind Corner Cabinet

SKU	Dimensions
BBC42	42"W x 30"H x 23 7/8"D
BBC45	45"W x 30"H x 23 7/8"D

Includes:

- One (1) universal cabinet box.
- One (1) door with HINGE105° (6 ways & soft close).
- One (1) adjustable shelf with shelf pegs.
- One (1) 6" filler for adjusting the spacing.
- Six (6) adjustable Legs 4 1/4"~5 1/4"
- Screws or camlock, dowels and required hardware.

NOTE:

- Use BEP/MBEP panels to cover exterior sides if exposed.
- Need to install TK8/A-TK10/B-TK10 at the bottom of the cabinet.

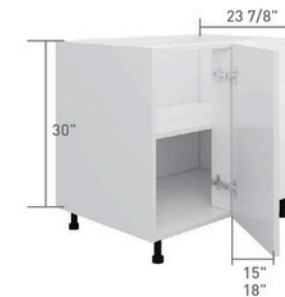

Cabinet Specifications

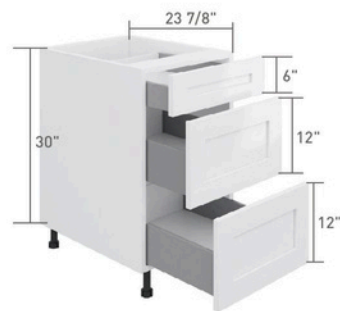

5. Base Corner Cabinet

SKU	Dimensions
BER33 [One (1) adjustable shelf with shelf pegs]	33"W x 30"H x 23 7/8"D
BER36 [One (1) adjustable shelf with shelf pegs]	36"W x 30"H x 23 7/8"D
BLS33 [One (1) Lazy Susan for BLS cabinet]	33"W x 30"H x 23 7/8"D
BLS36 [One (1) Lazy Susan for BLS cabinet]	36"W x 30"H x 23 7/8"D

Includes:

- One (1) universal cabinet box.
- Two (2) folding doors with HINGE135° (regular) and HINGE155° (soft close) .
- Seven (7) adjustable Legs 4 1/4"~5 1/4" for 33"W cabinet, nine (9) for 36"W.
- Screws or camlock, dowels and required hardware.

NOTE:

- Use BEP/MBEP panels to cover exterior sides if exposed.
- Need to install TK8/A-TK10/B-TK10 at the bottom of the cabinet.

6.3 Drawers Base Cabinet

SKU	Dimensions
3DB12	12"W x 30"H x 23 7/8"D
3DB15	15"W x 30"H x 23 7/8"D
3DB18	18"W x 30"H x 23 7/8"D
3DB21	21"W x 30"H x 23 7/8"D
3DB24	24"W x 30"H x 23 7/8"D
3DB27	27"W x 30"H x 23 7/8"D
3DB30	30"W x 30"H x 23 7/8"D
3DB33	33"W x 30"H x 23 7/8"D
3DB36	36"W x 30"H x 23 7/8"D

Includes:

- One (1) universal cabinet box.
- Three (3) drawers with metalbox and soft close slide.
- Four (4) adjustable Legs 4 1/4"~5 1/4" for 12"-33"W cabinet, six (6) for 36"W.
- Screws or camlock, dowels and required hardware.

NOTE:

- Use BEP/MBEP panels to cover exterior sides if exposed.
- Need to install TK8/A-TK10/B-TK10 at the bottom of the cabinet.

Cabinet Specifications

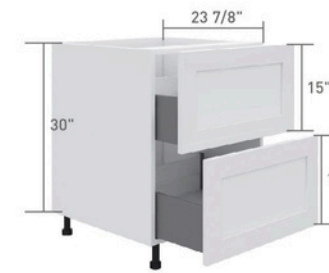

7.2 Drawers Base Cabinet

SKU	Dimensions
2DB30	30"W x 30"H x 23 7/8"D
2DB36	36"W x 30"H x 23 7/8"D

Includes:

- One (1) universal cabinet box.
- Two (2) drawers with metalbox and soft close slide.
- Four (4) adjustable Legs 4 1/4"~5 1/4" for 30"W cabinet, six (6) for 36"W.
- Screws or camlock, dowels and required hardware.

NOTE:

- Use BEP/MBEP panels to cover exterior sides if exposed.
- Need to install TK8/A-TK10/B-TK10 at the bottom of the cabinet.

8. Base Spice rack Cabinet

SKU	Dimensions
BSR06	6"W x 30"H x 23 7/8"D
BSR09	9"W x 30"H x 23 7/8"D
BSR12	12"W x 30"H x 23 7/8"D

Includes:

- One (1) universal cabinet box.
- One (1) door and spice rack for BSR cabinet.
- Two (2) adjustable Legs 4 1/4"~5 1/4" for 06"W cabinet, Four (4) for the others.
- Screws or camlock, dowels and required hardware.

NOTE:

- Use BEP/MBEP panels to cover exterior sides if exposed.
- Need to install TK8/A-TK10/B-TK10 at the bottom of the cabinet.

Cabinet Specifications



9-1. Base Full Height Cabinet 1 Door

SKU	Dimensions
B06FH	6"W x 30"H x 23 7/8"D
B09FH	9"W x 30"H x 23 7/8"D
B12FH	12"W x 30"H x 23 7/8"D
B15FH	15"W x 30"H x 23 7/8"D
B18FH	18"W x 30"H x 23 7/8"D
B21FH	21"W x 30"H x 23 7/8"D

Includes:

- One (1) universal cabinet box.
- One (1) door with HINGE105° (6 ways & soft close).
- One (1) adjustable shelf with shelf pegs .
- Two (2) adjustable Legs 4 1/4"~5 1/4" for 06"W cabinet, Four (4) for the others.
- Screws or camlock, dowels and required hardware.

NOTE:

- Use BEP/MBEP panels to cover exterior sides if exposed.
- Need to install TK8/A-TK10/B-TK10 at the bottom of the cabinet.

9-2. Base Full Height Cabinet 2 Door

SKU	Dimensions
B24FH	24"W x 30"H x 23 7/8"D
B27FH	27"W x 30"H x 23 7/8"D
B30FH	30"W x 30"H x 23 7/8"D
B33FH	33"W x 30"H x 23 7/8"D
B36FH	36"W x 30"H x 23 7/8"D

Includes:

- One (1) universal cabinet box.
- One (1) door with HINGE105° (6 ways & soft close).
- One (1) adjustable shelf with shelf pegs.
- Four (4) adjustable Legs 4 1/4"~5 1/4" for 24"-33"W cabinet, six (6) for 36"W.
- Screws or camlock, dowels and required hardware.

NOTE:

- Use BEP/MBEP panels to cover exterior sides if exposed.
- Need to install TK8/A-TK10/B-Tk10 at the bottom of the cabinet.



Cabinet Specifications



10. Base Microwave Cabinet

SKU	Dimensions
BMC24	24"W x 30"H x 23 7/8"D
BMC30	30"W x 30"H x 23 7/8"D

Includes:

- One (1) universal cabinet box.
- One (1) drawer with metalbox and soft close slide.
- One (1) 2" filler at the top to adjust the spacing.
- Four (4) adjustable Legs 4 1/4"~5 1/4".
- Screws or camlock, dowels and required hardware.

NOTE:

- Use BEP/MBEP panels to cover exterior sides if exposed.
- Need to install TK8/A-TK10/B-TK10 at the bottom of the cabinet.

11-1. Wall Cabinet 1 Door

SKU	Dimensions
W0930	9"W x 30"H x 12"D
W1230	12"W x 30"H x 12"D
W1530	15"W x 30"H x 12"D
W1830	18"W x 30"H x 12"D
W2130	21"W x 30"H x 12"D
W0936	9"W x 36"H x 12"D
W1236	12"W x 36"H x 12"D
W1536	15"W x 36"H x 12"D

Includes:

- One (1) universal cabinet box.
- One (1) door with HINGE105° (6 ways & soft close).
- Two (2) adjustable shelves with shelf pegs for 30" & 36"H cabinet .
- Three (3) adjustable shelves with shelf pegs for 42"H cabinet .
- Screws or camlock, dowels and required hardware.

NOTE:

- Use WEP/MWEP panels to cover exterior sides if exposed.





11-2.Wall Cabinet 1 Door

SKU	Dimensions
W1836	18"W x 36"H x 12"D
W2136	21"W x 36"H x 12"D
W0942	9"W x 42"H x 12"D
W1242	12"W x 42"H x 12"D
W1542	15"W x 42"H x 12"D
W1842	18"W x 42"H x 12"D
W2142	21"W x 42"H x 12"D

- Includes:**
- One (1) universal cabinet box.
 - One (1) door with HINGE105° (6 ways & soft close).
 - Two (2) adjustable shelves with shelf pegs for 30" & 36"H cabinet .
 - Three (3) adjustable shelves with shelf pegs for 42"H cabinet .
 - Screws or camlock, dowels and required hardware.

NOTE:
- Use WEP/MWEP panels to cover exterior sides if exposed.

12-1.Wall Cabinet 2 Door



SKU	Dimensions
W2430	24"W x 30"H x 12"D
W2730	27"W x 30"H x 12"D
W3030	30"W x 30"H x 12"D
W3330	33"W x 30"H x 12"D
W3630	36"W x 30"H x 12"D
W2436	24"W x 36"H x 12"D
W2736	27"W x 36"H x 12"D
W3036	30"W x 36"H x 12"D
W3336	33"W x 36"H x 12"D
W3636	36"W x 36"H x 12"D
W2442	24"W x 42"H x 12"D

- Includes:**
- One (1) universal cabinet box.
 - Two (2) doors with HINGE105° (6 ways & soft close).
 - Two (2) adjustable shelves with shelf pegs for 30" & 36"H cabinet .
 - Three (3) adjustable shelves with shelf pegs for 42"H cabinet .
 - Screws or camlock, dowels and required hardware.

NOTE:
- Use WEP/MWEP panels to cover exterior sides if exposed.



12-2.Wall Cabinet 2 Door

SKU	Dimensions
W2742	27"W x 42"H x 12"D
W3042	30"W x 42"H x 12"D
W3342	33"W x 42"H x 12"D
W3642	36"W x 42"H x 12"D

- Includes:**
- One (1) universal cabinet box.
 - Two (2) doors with HINGE105° (6 ways & soft close).
 - Two (2) adjustable shelves with shelf pegs for 30" & 36"H cabinet .
 - Three (3) adjustable shelves with shelf pegs for 42"H cabinet .
 - Screws or camlock, dowels and required hardware.

NOTE:
- Use WEP/MWEP panels to cover exterior sides if exposed.

13-1.Wall Short Cabinet

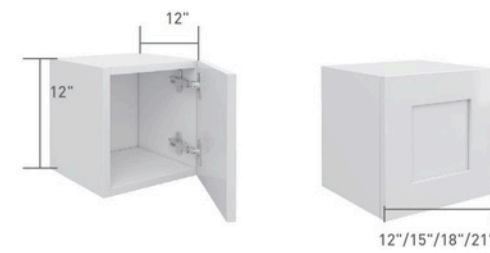

SKU	Dimensions
W1212	12"W x 12"H x 12"D
W1512	15"W x 12"H x 12"D
W1812	18"W x 12"H x 12"D
W2112	21"W x 12"H x 12"D

- Includes:**
- One (1) universal cabinet box.
 - One (1) door with HINGE105° (6 ways & soft close).
 - No Shelf.
 - Screws or camlock, dowels and required hardware.

NOTE:
- Use WEP/MWEP panels to cover exterior sides if exposed.

Cabinet Specifications

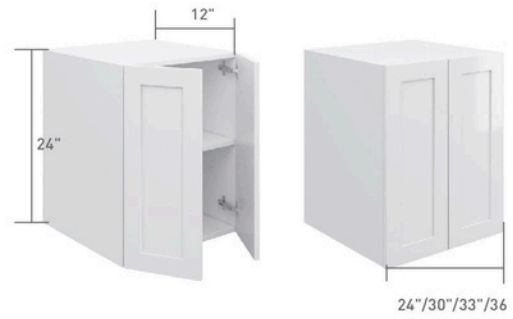
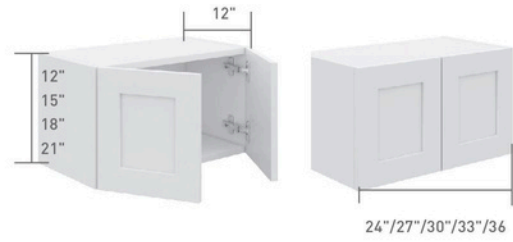

13-2.Wall Short Cabinet

SKU	Dimensions
W2412	24"W x 12"H x 12"D
W2712	27"W x 12"H x 12"D
W3012	30"W x 12"H x 12"D
W3312	33"W x 12"H x 12"D
W3612	36"W x 12"H x 12"D
W2415	24"W x 15"H x 12"D
W3015	30"W x 15"H x 12"D
W3315	33"W x 15"H x 12"D
W3615	36"W x 15"H x 12"D
W2418	24"W x 18"H x 12"D
W3018	30"W x 18"H x 12"D
W3318	33"W x 18"H x 12"D
W3618	36"W x 18"H x 12"D
W2421	24"W x 21"H x 12"D
W3021	30"W x 21"H x 12"D
W3321	33"W x 21"H x 12"D
W3621	36"W x 21"H x 12"D
W2424	24"W x 24"H x 12"D
W3024	30"W x 24"H x 12"D
W3324	33"W x 24"H x 12"D
W3624	36"W x 24"H x 12"D

Includes:

- One (1) universal cabinet box.
- Two (2) doors with HINGE105° (6 ways & soft close).
- No shelf in 12" & 15" & 18" & 21" H.
- One (1) adjustable shelf with shelf pegs for 24" H cabinet .
- Screws or camlock, dowels and required hardware.

NOTE:

- Use WEP/MWEP panels to cover exterior sides if exposed.

Cabinet Specifications

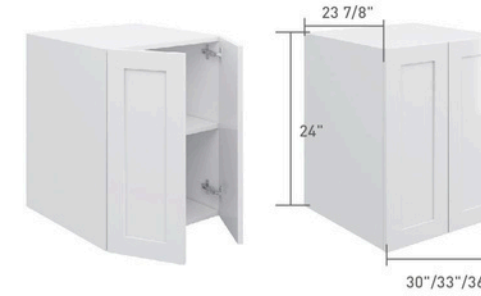
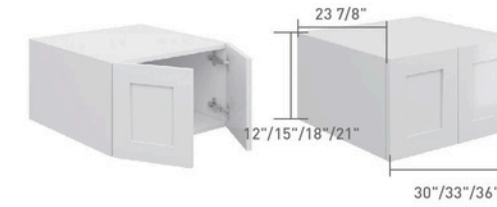

14.Wall Cabinet Fridge 2 Door

SKU	Dimensions
W301224	30"W x 12"H x 23 7/8"D
W331224	33"W x 12"H x 23 7/8"D
W361224	36"W x 12"H x 23 7/8"D
W301524	30"W x 15"H x 23 7/8"D
W331524	33"W x 15"H x 23 7/8"D
W361524	36"W x 15"H x 23 7/8"D
W301824	30"W x 18"H x 23 7/8"D
W331824	33"W x 18"H x 23 7/8"D
W361824	36"W x 18"H x 23 7/8"D
W302124	30"W x 21"H x 23 7/8"D
W332124	33"W x 21"H x 23 7/8"D
W362124	36"W x 21"H x 23 7/8"D
W302424	30"W x 24"H x 23 7/8"D
W332424	33"W x 24"H x 23 7/8"D
W362424	36"W x 24"H x 23 7/8"D

Includes:

- One (1) universal cabinet box.
- Two (2) doors with HINGE105° (6 ways & soft close).
- No shelf in 12" & 15" & 18" H.
- One (1) adjustable shelf with shelf pegs for 24" H cabinet .
- Screws or camlock dowels and required hardware.

NOTE:

- Use WEP/MWEP panels to cover exterior sides if exposed.

Cabinet Specifications

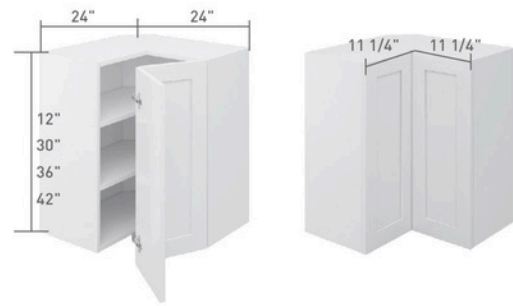

15. Wall Easy Reach Cabinet

SKU	Dimensions
WER2412	24"W x 12"H x 12"D
WER2430	24"W x 30"H x 12"D
WER2436	24"W x 36"H x 12"D
WER2442	24"W x 42"H x 12"D

Includes:

- One (1) universal cabinet box.
- Two (2) folding doors with HINGE135° (regular) and HINGE155° (soft close).
- No shelf in 12"H.
- Two (2) adjustable shelves with shelf pegs for 30" & 36"H cabinet .
- Three (3) adjustable shelves with shelf pegs for 42"H cabinet .
- Screws or camlock, dowels and required hardware.

NOTE:

- Use WEP/MWEP panels to cover exterior sides if exposed.

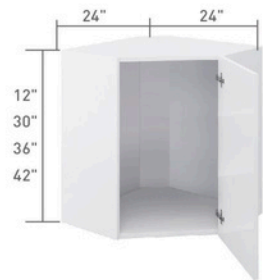

16. Wall Diagonal Cabinet

SKU	Dimensions
WDC2412	24"W x 12"H x 12"D
WDC2430	24"W x 30"H x 12"D
WDC2436	24"W x 36"H x 12"D
WDC2442	24"W x 42"H x 12"D

Includes:

- One (1) universal cabinet box.
- One (1) door with HINGE45° (soft close).
- No shelf in 12"H.
- Two (2) adjustable shelves with shelf pegs for 30" & 36"H cabinet .
- Three (3) adjustable shelves with shelf pegs for 42"H cabinet .
- Screws or camlock, dowels and required hardware.

NOTE:

- Use WEP/MWEP panels to cover exterior sides if exposed.

Cabinet Specifications

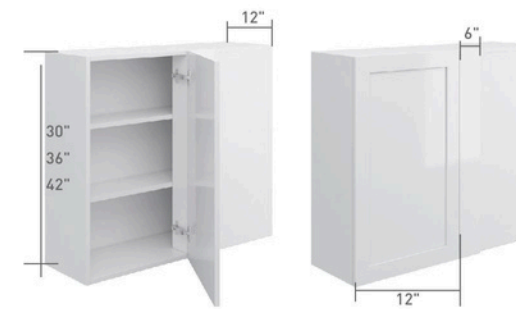

17. Wall Blind Corner

SKU	Dimensions
WBC2730	27"W x 30"H x 12"D
WBC2736	27"W x 36"H x 12"D
WBC2742	27"W x 42"H x 12"D

Includes:

- One (1) universal cabinet box.
- One (1) door with HINGE105° (soft close).
- Two (2) adjustable shelves with shelf pegs for 30" & 36"H cabinet .
- Three (3) adjustable shelves with shelf pegs for 42"H cabinet .
- One (1) 6" filler for adjusting the spacing.
- Screws or camlock, dowels and required hardware.

NOTE:

- Use WEP/MWEP panels to cover exterior sides if exposed.

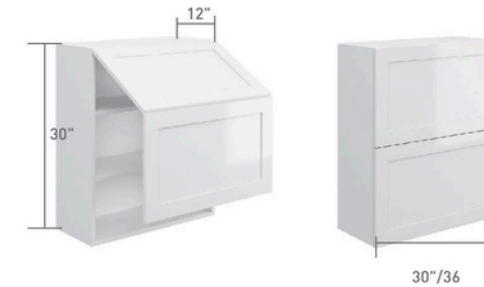

18. Wall Bi-Fold

SKU	Dimensions
WBF3030	30"W x 30"H x 12"D
WBF3630	36"W x 30"H x 12"D

Includes:

- One (1) universal cabinet box.
- Two (2) doors with BLUM fold lift and regular hinges.
- Two (2) adjustable shelves with shelf pegs
- Screws or camlock, dowels and required hardware.

NOTE:

- Use WEP/MWEP panels to cover exterior sides if exposed.
- 30"W require two hinges
- 36"W require three hinges

Cabinet Specifications

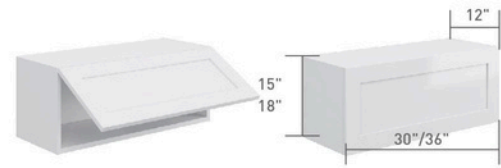

19. Wall Stay Lift

SKU	Dimensions
WSL3015	30"W x 15"H x 12"D
WSL3615	36"W x 15"H x 12"D
WSL3018	30"W x 18"H x 12"D
WSL3618	36"W x 18"H x 12"D

Includes:

- One (1) universal cabinet box.
- One (1) doors with BLUM stay lift HINGE105° (6 ways & soft close).
- No Shelf .
- Screws or camlock, dowels and required hardware.

NOTE:

- Use WEP/MWEP panels to cover exterior sides if exposed.
- 30"W require two hinges
- 36"W require three hinges

20 .Pantry Cabinet 1 Side Door

SKU	Dimensions
PC1884	18"W x 84"H x 23 7/8"D
PC1890	18"W x 90"H x 23 7/8"D
PC1896	18"W x 96"H x 23 7/8"D

Includes:

- One (1) universal cabinet box.
- Two (2) doors with HINGE105° (6 ways & soft close).
- Three (3) adjustable shelves with shelf pegs and One (1) fixed shelf.
- Four (4) adjustable Legs 4 1/4"~5 1/4"
- Screws or camlock, dowels and required hardware.

NOTE:

- Height of cabinet include feet's height.
- Use REF/MTEP panels to cover exterior sides if exposed.
- Need to install TK8/A-TK10/B-TK10 at the bottom of the cabinet.
- Height includes leg

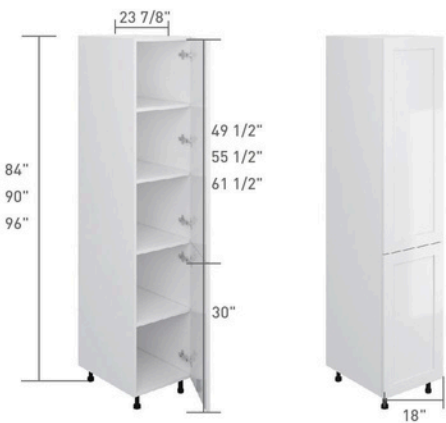

Cabinet Specifications



21. Pantry Cabinet 2 Full Door

SKU	Dimensions
PC2484	24"W x 84"H x 23 7/8"D
PC3084	30"W x 84"H x 23 7/8"D
PC2490	24"W x 90"H x 23 7/8"D
PC3090	30"W x 90"H x 23 7/8"D
PC2496	24"W x 96"H x 23 7/8"D
PC3096	30"W x 96"H x 23 7/8"D

Includes:

- One (1) universal cabinet box.
- Four (4) doors with HINGE105° (6 ways & soft close).
- Three (3) adjustable shelves with shelf pegs and One (1) fixed shelf.
- Four (4) adjustable Legs 4 1/4"~5 1/4"
- Screws or camlock, dowels and required hardware.

NOTE:

- Height of cabinet include feet's height.
- Use REF/MTEP panels to cover exterior sides if exposed.
- Need to install TK8/A-TK10/B-TK10 at the bottom of the cabinet.
- Height includes leg

22. Double Oven Cabinet

SKU	Dimensions
DOC3084	30"W x 84"H x 23 7/8"D
DOC3090	30"W x 90"H x 23 7/8"D
DOC3096	30"W x 96"H x 23 7/8"D

Includes:

- One (1) universal cabinet box.
- Two (2) doors with HINGE105° (6 ways & soft close).
- One (1) drawer with metalbox and soft close slide.
- One (1) 2 1/2" filler at the top and bottom of cut-out space.
- One (1) adjustable shelf with shelf pegs on the top for 96" cabinet.
- Four (4) adjustable Legs 4 1/4"~5 1/4"
- Screws or camlock, dowels and required hardware.

NOTE:

- Height of cabinet include feet's height.
- Appliance cut-out height is 55 1/8"
- Use REF/MTEP panels to cover exterior sides if exposed.
- Need to install TK8/A-TK10/B-TK10 at the bottom of the cabinet.
- Height includes leg

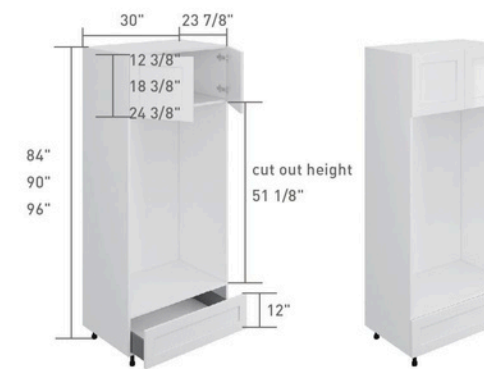

Cabinet Specifications

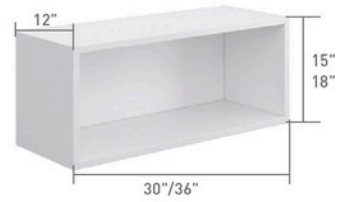

23.Wall Open Box

SKU	Dimensions
WOC3015	30"W x 15"H x 12"D
WOC3615	36"W x 15"H x 12"D
WOC3018	30"W x 18"H x 12"D
WOC3618	36"W x 18"H x 12"D
WRC0630	6"W x 30"H x 12"D
WRC0636	6"W x 36"H x 12"D
WRC0642	6"W x 42"H x 12"D

Includes:

- One (1) cabinet box made of door material.
- No shelf for WOC cabinet.
- Four (4) fixed shelves for WRC cabinet.
- Screws or camlock, dowels and required hardware.

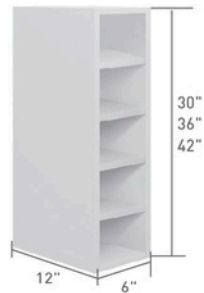

24.Wall Microwave Cabinet

SKU	Dimensions
WMC2418	24"W x 18"H x 12"D
WMC3018	30"W x 18"H x 12"D

Includes:

- One (1) cabinet box made of door material.
- Screws or camlock, dowels and required hardware.

NOTE:

- The bottom panel extends out for 6" to hold the microwave.

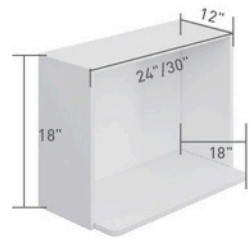

25.Dishwasher End Panel

SKU	Dimensions
DWEP3	3"W x 34 1/2"H x 24 3/4"D

Includes:

- One (1) return panel 34 1/2"H x 24"D
- One (1) filler 3"W x 34 1/2"H x 3/4"D
- Screws, dowels and required hardware.

NOTE:

- The filler cover return panel.



Cabinet Specifications



26.Panel & Toe Kick

	SKU	Dimensions
Base Panel	BEP24	24 3/4"W x 34 1/2"H
	BEP26	25 1/2"W x 34 1/2"H
	BEP36	37 1/2"W x 34 1/2"H
	BEP48	49 1/2"W x 34 1/2"H
Wall Panel	WEP1230	12 3/4"W x 30"H
	WEP1236	12 3/4"W x 36"H
	WEP1242	12 3/4"W x 42"H
Fridge Panel	REF2496	24 3/4"W x 96"H
	REF24105	24 3/4"W x 105"H
Island Back Panel	REF3696	36"W x 96"H
Toe Kick	TK8	96"W x 4 1/2"H
Dishwasher Panel	W2430S (Matching door profile)	24"W x 30"H

Includes:

- One (1) decorative panel.

27.Filler

SKU	Dimensions
WF330	3"W x 30"H
WF336	3"W x 36"H
WF342	3"W x 42"H
TF396	3"W x 96"H
WF630	6"W x 30"H
WF636	6"W x 36"H
WF642	6"W x 42"H
TF696	6"W x 96"H

Includes:

- One (1) filler.
- One (1) Carcass panel in same size to easier installation.

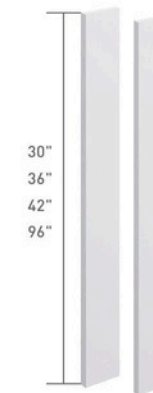

Cabinet Specifications

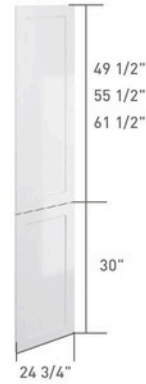
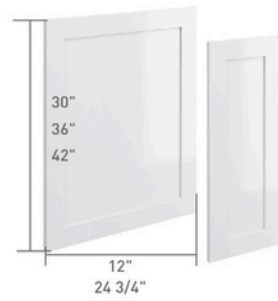

28.Shaker Style End Panel

SKU	Dimensions
MWEP1230	12"W x 30"H
MWEP1236	12"W x 36"H
MWEP1242	12"W x 42"H
MBEP2430	24 3/4"W x 30"H
MTEP2484	24 3/4"W x 79 1/2"H
MTEP2490	24 3/4"W x 85 1/2"H
MTEP2496	24 3/4"W x 91 1/2"H

Includes:
- One (1) decorative panel.

29-1.Exclusive for Lacquer Shaker Finish

SKU	Dimensions
CVCM	2 7/8"W x 2 7/8" H x 96"L
CM4	3 1/7"W x 3 1/7"H x 96"L
BM8	3/4"W x 4 1/2"H x 96"L
RISER	3"W x 4"H x 96"L
SM8	1/4"W x 3/4"H x 96"L
LM8	1 1/2"W x 2"H x 96"L
OCM8	1/4"W x 1 1/4"H x 96"L

Includes:
- One (1) piece of moulding

NOTE:
- CVCM and CM4 should be used with RISER

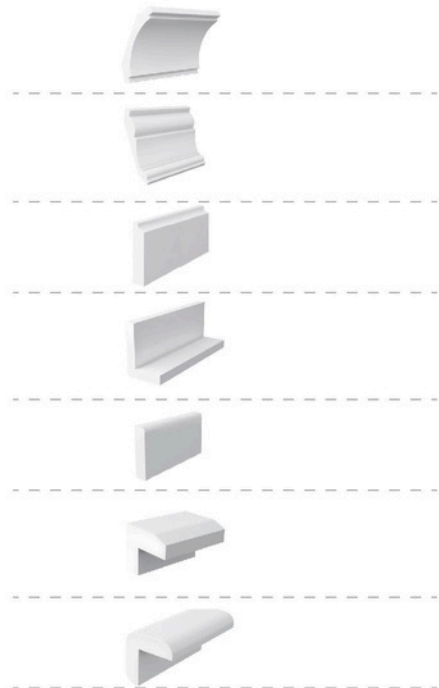

Cabinet Specifications



29-2.Exclusive for Shaker

SKU	Dimensions
VAL36	36"W x 4 1/2"H x 3/4"D
VAL48	48"W x 4 1/2"H x 3/4"D















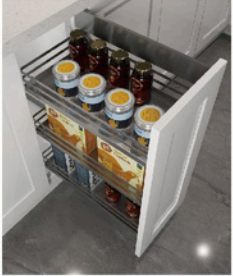

Includes:
- One (1) curved valance

29-3.Exclusive for Shaker

SKU	Dimensions
COBEL-S	3"W x 9"H x 9"D

Includes:
- One (1) corbel.

Cabinet Specifications

30.Hardware			
Overall Look	SKU	Overall Look	SKU
	ROT18 ROT24 ROT30		DRAWER-LOW
	BLS33 TRAY BLS36 TRAY ★ Applied with BLS cabinets		HINGE45 ★ Applied with WDC cabinets
	BSR06-SPICE RACK BSR09-SPICE RACK BSR12-SPICE RACK ★ Applied with BSR cabinets		HINGE105 ★ Six-way adjustable 105 degree opening soft close hinges
	BTC18-TRASH CAN ★ Applied with BTC18 cabinets		HINGE135 ★ Applied with BLS33 & BLS36 cabinets
	BTC18-TRASH CAN ★ Applied with BTC18 cabinets		HINGE155 ★ Applied with BLS33 & BLS36 cabinets
	A-TK10		BLUM STAY LIFT
	B-TK10		BLUM FOLD LIFT
	DRAWER-HIGH		PLASTIC LEG

Cabinet Specifications



31-1.Glass Door	
SKU	Dimensions
GL-W1230	12"W x 30"H
GL-W1236	12"W x 36"H
GL-W1242	12"W x 42"H
GL-W1530	15"W x 30"H
GL-W1536	15"W x 36"H
GL-W1542	15"W x 42"H
GL-W1830	18"W x 30"H
GL-W1836	18"W x 36"H
GL-W1842	18"W x 42"H

Includes:

- One (1) Aluminum fram glass door.

31-2.Clear Glass Door	
SKU	Dimensions
GD-W1212	12"W x 12"H
GD-W1230	12"W x 30"H
GD-W1236	12"W x 36"H
GD-W1242	12"W x 42"H
GD-W1512	15"W x 12"H
GD-W1530	15"W x 30"H
GD-W1536	15"W x 36"H
GD-W1542	15"W x 42"H
GD-W1812	18"W x 12"H
GD-W1830	18"W x 30"H
GD-W1836	18"W x 36"H
GD-W1842	18"W x 42"H
GD-W2112	21"W x 12"H
GD-W2712	27"W x 12"H
GD-WDC2412	15 1/2"W x 12"H
GD-WDC2430	15 1/2"W x 30"H
GD-WDC2436	15 1/2"W x 36"H
GD-WDC2442	15 1/2"W x 42"H

Includes:

- One (1) Wooden fram glass door.